

Sold

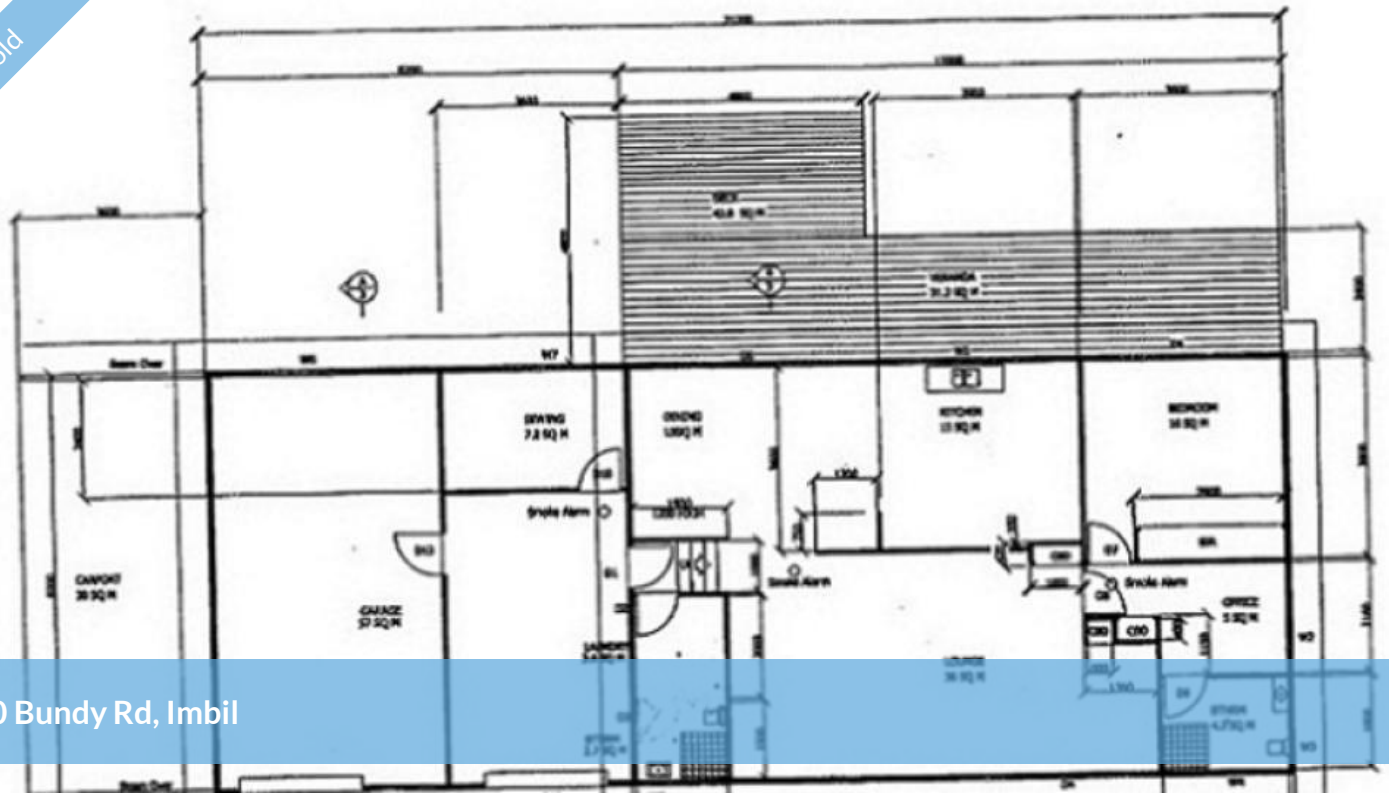

60 Bundy Rd, Imbil



## LIVING ON THE EDGE!

60 Bundy Rd is perfectly positioned, on the edge of Imbil village and the edge of Imbil State Forest.

The property is a sanctuary, where it is a blurred line between this 5 acres and the thousands of acres in the State Forest next door. The Wallabies don't know where the line is either! Nestled into the spot is a rather unique home with a distinctive curved roof line.

You enter the home, through a lattice screen and via a small front deck, to a generous sized lounge room. This room features high ceilings and polished timber floors and has a slow combustion heater, for winter nights, that takes pride of place in the corner. However, it is the kitchen that is the centrepiece of this home! It is a wraparound kitchen, with a chopping block at the centre of long benches and an extensive range of storage options. Kitchen features include a 5 burner gas cook top, an excellent pantry and a large appliance cupboard. The dining room is separated from the kitchen by a breakfast bar. Northerly views from here are only surpassed by the view from the front deck.

Bedroom #1 has double built-in-robos and sliding door access to the front deck. The study and en-suite combine with the bedroom to make this a master bedroom suite. There is a second bathroom as we head towards the second bedroom at the other end of the home. A garage conversion is a great option for a third bedroom, if that's on your list!

🛏️ 2 🚿 2 🚗 4 📏 20,100 m<sup>2</sup>

**Price** SOLD for \$332,500  
**Property Type** Residential  
**Property ID** 77  
**Land Area** 20,100 m<sup>2</sup>

### Agent Details

Ron Jeffery - 0402 223 201

### Office Details

120 Yabba Rd, Imbil  
07 5488 6000

7 Elizabeth St, Kenilworth  
07 5446 0164



**RJR Property**

One of the garages is currently used as a much loved workshop. There are plenty of other car parking options with two single carports, one that incorporates a lined studio. The home has a finish that makes it almost zero maintenance.

But, the deck is the place to be! It is north facing, wide and very usable. You could lose many hours here each day, just watching the Wallabies graze. Other people travel for miles to enjoy the forest. Here, it is right on your doorstep. A cottage in the woods!

Call Ron to arrange your inspection.