

Sold

46 Michelle Court, Imbil

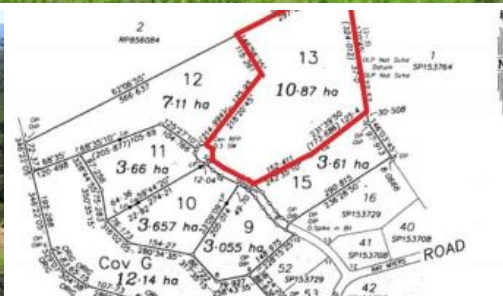

MAKE AN OFFER - ITS GOT TO GO!

Almost 27 acres at Imbil in the Mary Valley, for under \$250,000!

This is a great block! It has an east to north-easterly aspect and an east to north-easterly view. PERFECT!

Michelle Ct is a small cul-de-sac, sealed road off the end of Ray Myers Rd just minutes from the village of Imbil. You are less than 30 minutes from Gympie.

The property has a 150m frontage to the road but takes its access off the cul-de-sac end. This is a 10.87Ha (almost 27 acre) property. It has a mix of grazing and natural bush (probably greater than 50% grazing) and is almost completely fenced.

Build to take in the views or tuck yourself away to enjoy total privacy, the choice is yours!

Call the team at Ron Jeffery Realty to arrange your personal inspection.

It's got to go!

109,000 m²

Price	SOLD for \$235,000
Property Type	Residential
Property ID	168
Land Area	109,000 m ²

Agent Details

Ian Naylor - 0466 341 065
Ron Jeffery - 0402 223 201

Office Details

120 Yabba Rd, Imbil
07 5488 6000

7 Elizabeth St, Kenilworth
07 5446 0164



RJR Property